



NEVILLE

PRESS & SHEAR LTD

Specialists In Precision Fabricated Assemblies

Neville Press & Shear has attracted the attention of many of the major modular building manufacturers such as Advance Housing, Britspace, & Kingspan. By working closely with their design teams and engineers, from either a concept or "design drawings", Neville Press & Shear aims to provide engineering solutions to suit their project requirements, including, if necessary, the manufacturing of sample products or a 'prototype'.

Neville Press & Shear specialise in the design and manufacture of precision sheet metal components and fabricated assemblies. We continuously invest in state of the art production technology which enables us to match the most stringent demands in customer service.

Plant & Machinery

CNC Press Braking 220 Tonnes (up to 6000mm)

CNC Extrusion Milling (up to 8000mm)

CNC Extrusion Sawing (up to 8000mm)

CNC Punching (6000mm x 1600mm)

CNC Guillotining (up to 6000mm)

Tig & Mig Welding Facilities



Unit 4b, Park Lane Business Park Kirkby-In-Ashfield, Notts, England. Ng17 9LE
Tel: 00 44 (0)1623 722779 Fax: 00 44 (0)1623 722276
www.nevilles.co.uk e-mail : nps@nevilles.co.uk



NEVILLE PRESS & SHEAR LTD

Neville Press & Shear manufacture studs and channels up to 6 meters long in Steel & Aluminum. We assemble floor and ceiling modular pods for apartments, kitchens & bathrooms.

Example Products

Galvanised steel stud and channels

Specifically for UK modular housing market (up to 6 meters in length)

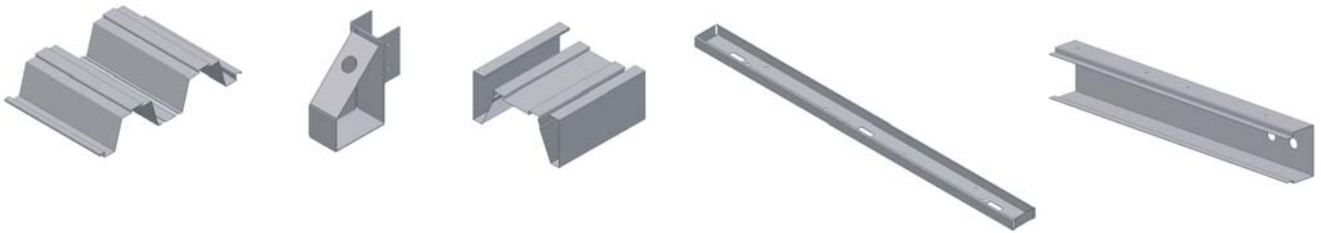

Galvanised Frames

Specifically for UK modular housing market

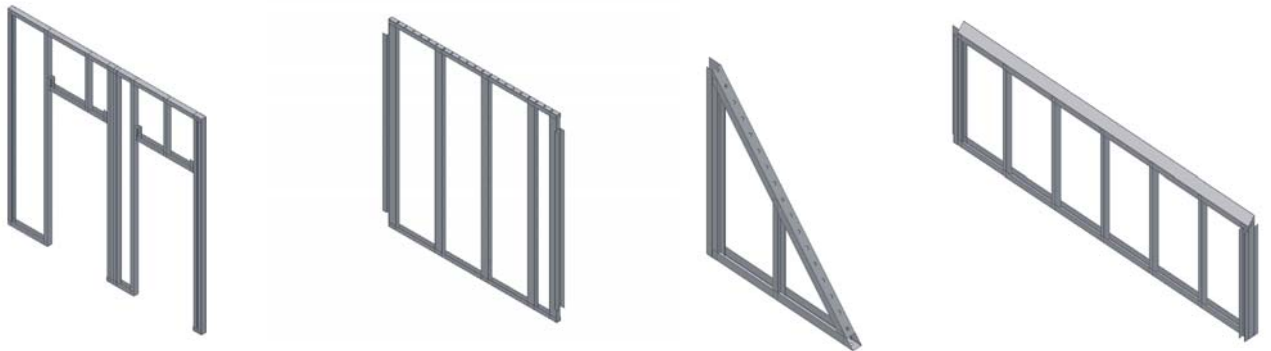

Galvanised Kitchen & Bathroom Floor & Ceiling Cassette

Specifically for UK modular housing market

